



**MIDA**

PERFORACIONES ESPECIALES



La imagen es a modo de referencia.

## ESPECIFICACIONES

### MATERIALES FRECUENTES

#### HIERRO

Espesores: 0,9 / 1,25 / 1,6

Medidas: 1000x2000

#### GALVANIZADO

Espesores: 0,9 / 1,25 / 1,6

Medidas: 1000x2000

#### ALUMINIO

Espesores: 1,5

Medidas: 1200x2400

#### ACERO INOXIDABLE

Espesores: 1 / 1,2 / 1,5

Medidas: 1000x2000 /  
1250x2500

### PERFORACIONES

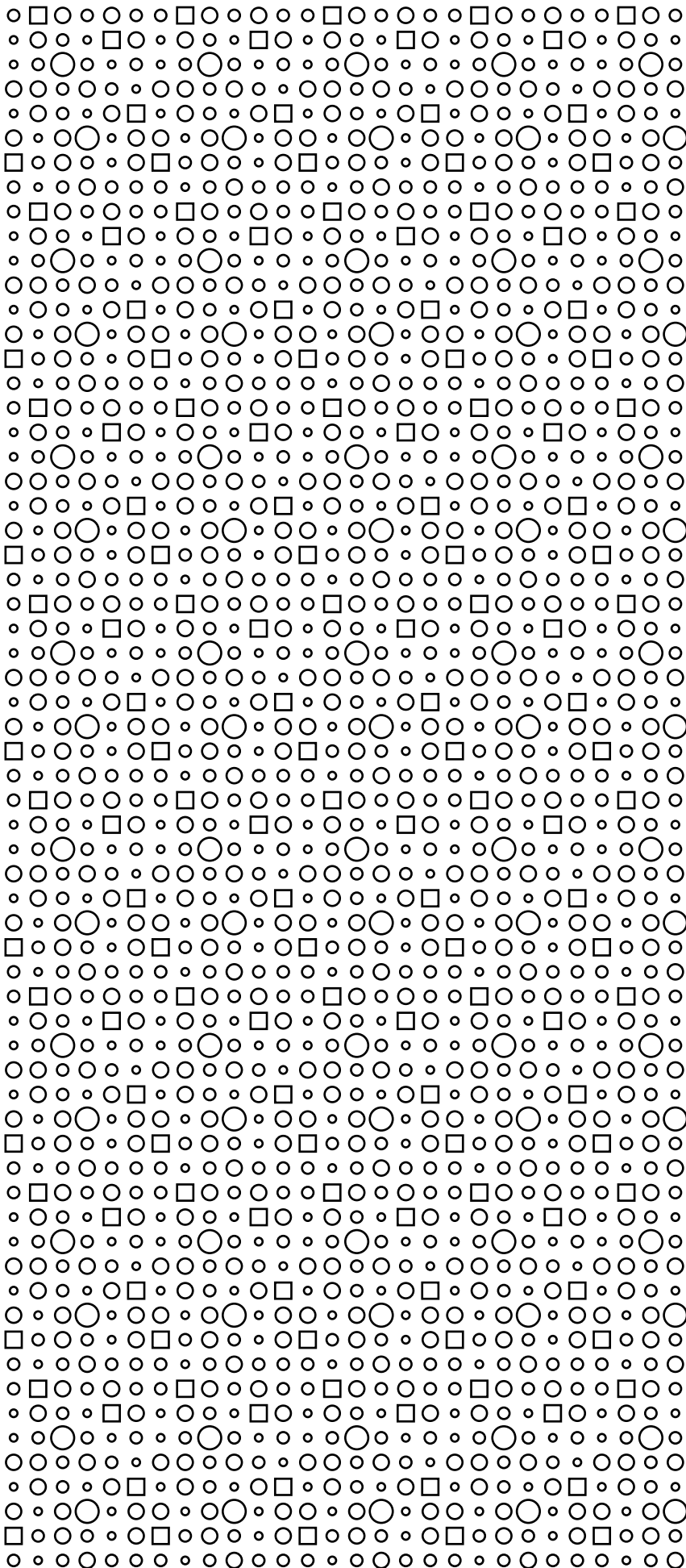
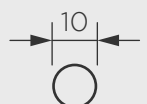
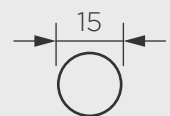
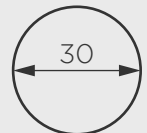
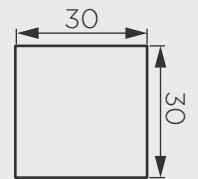

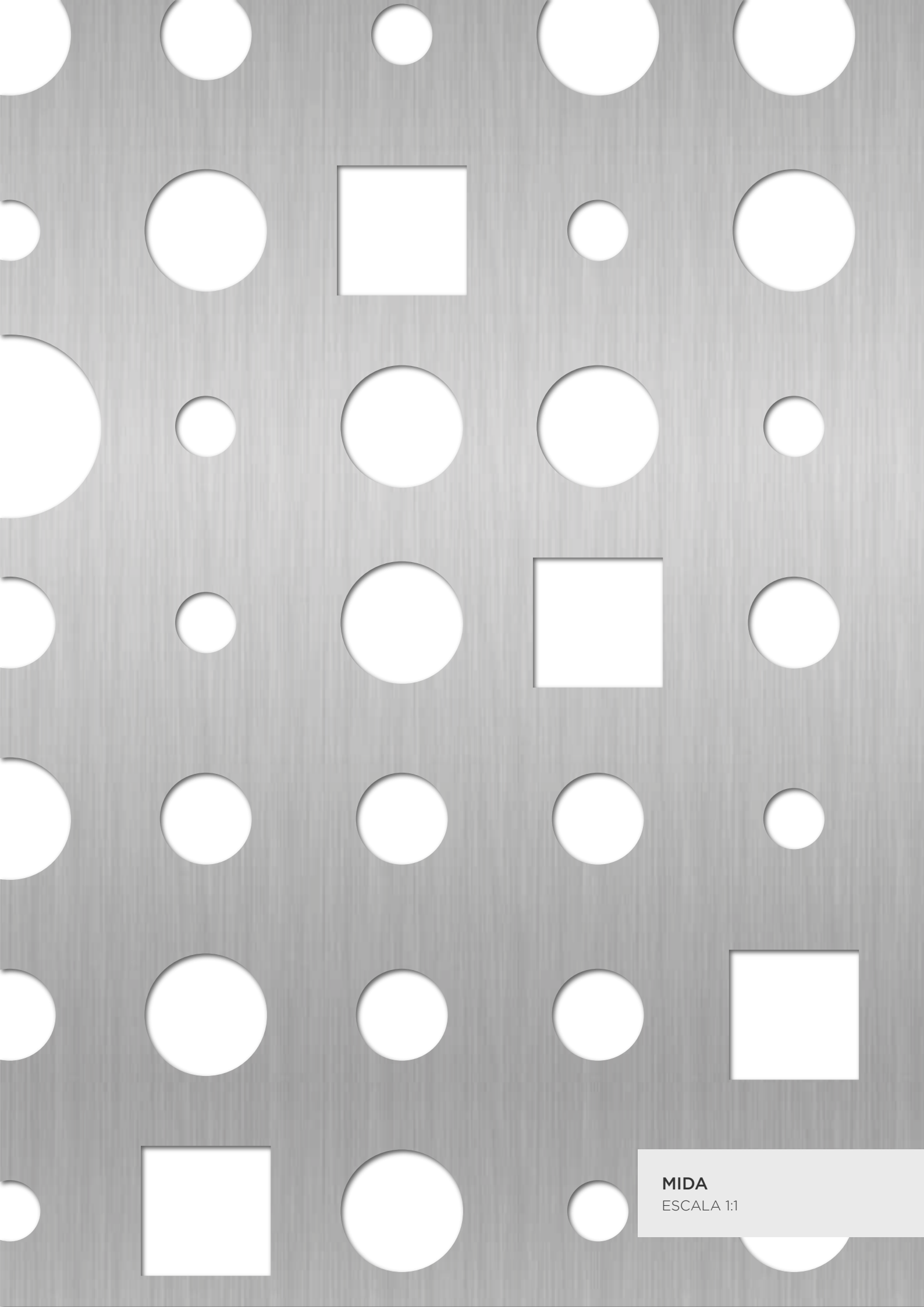

**MIDA**  
ESCALA 1:1